

# CPAP Pro “No Mask” Parts Diagram

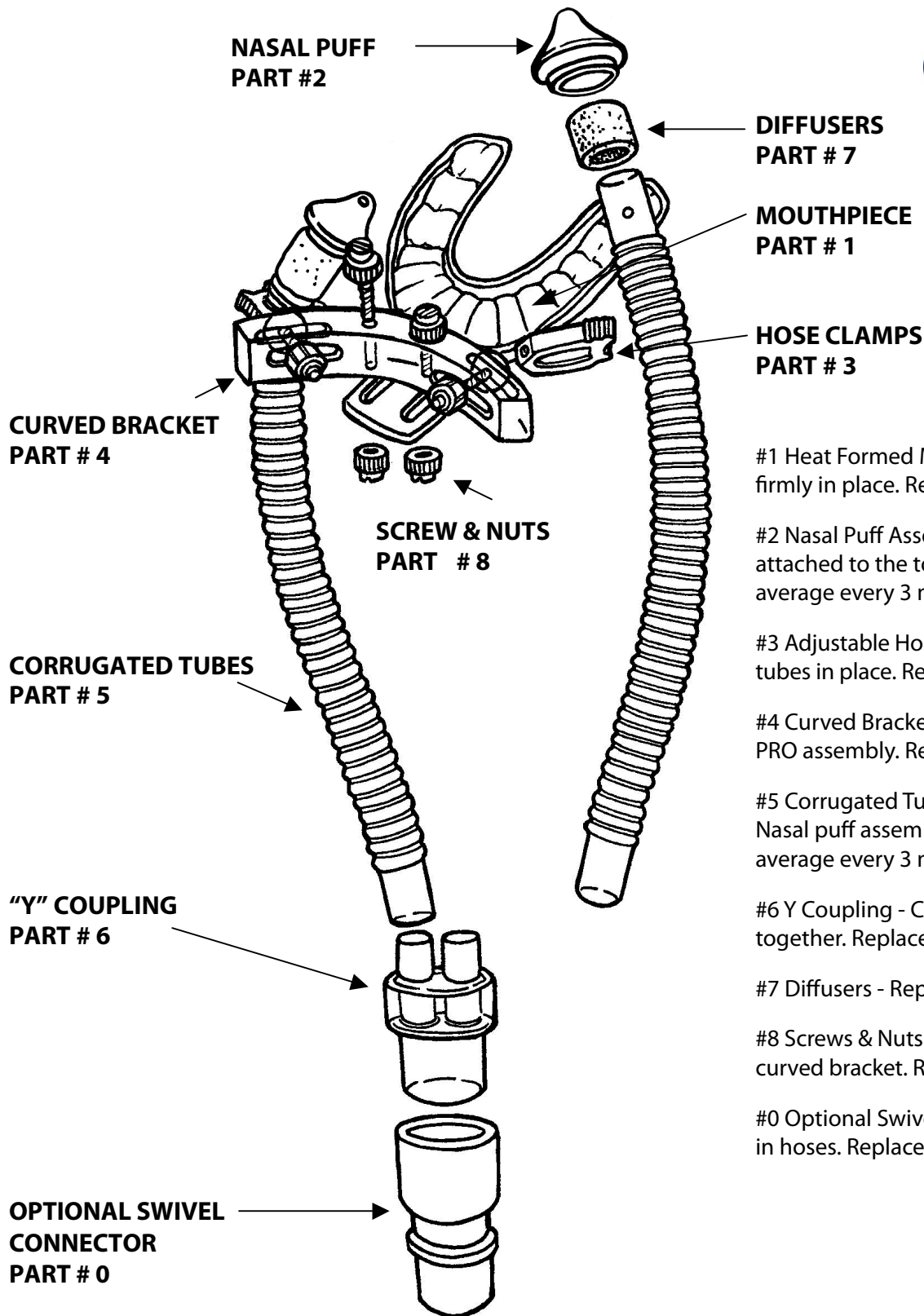

**DIFFUSERS  
PART # 7**

**MOUTHPIECE  
PART # 1**

**HOSE CLAMPS  
PART # 3**

**CURVED BRACKET  
PART # 4**

**SCREW & NUTS  
PART # 8**

**CORRUGATED TUBES  
PART # 5**

**“Y” COUPLING  
PART # 6**

**OPTIONAL SWIVEL  
CONNECTOR  
PART # 0**

#1 Heat Formed Mouthpiece - Holds the CPAP PRO firmly in place. Replace on average every 3 months.

#2 Nasal Puff Assembly - Special nose-fitting seals attached to the top of the CPAP PRO. Replace on average every 3 months.

#3 Adjustable Hose Clamps - Clamps hold the plastic tubes in place. Replace on average every 6 months.

#4 Curved Bracket - Main plate that holds the CPAP PRO assembly. Replace as needed.

#5 Corrugated Tubes - Tubes that connect the Nasal puff assembly to the Y coupling. Replace on average every 3 months.

#6 Y Coupling - Connects the corrugated tubes together. Replace as needed.

#7 Diffusers - Replace on average every two weeks

#8 Screws & Nuts - Hold the mouthpiece to the curved bracket. Replace on average every 6 months.

#0 Optional Swivel Connector - Helps prevent 'kink' in hoses. Replace as needed.